

CAVE ROCK ESTATES
GENERAL IMPROVEMENT DISTRICT

NEVADA TAHOE CONSERVATION DISTRICT

CAVE ROCK GID STORMWATER SYSTEM

RETROFIT PROJECT

IN THE COUNTY OF DOUGLAS

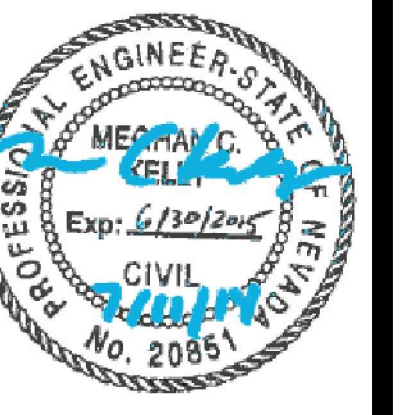

PLAN

NOT TO SCALE

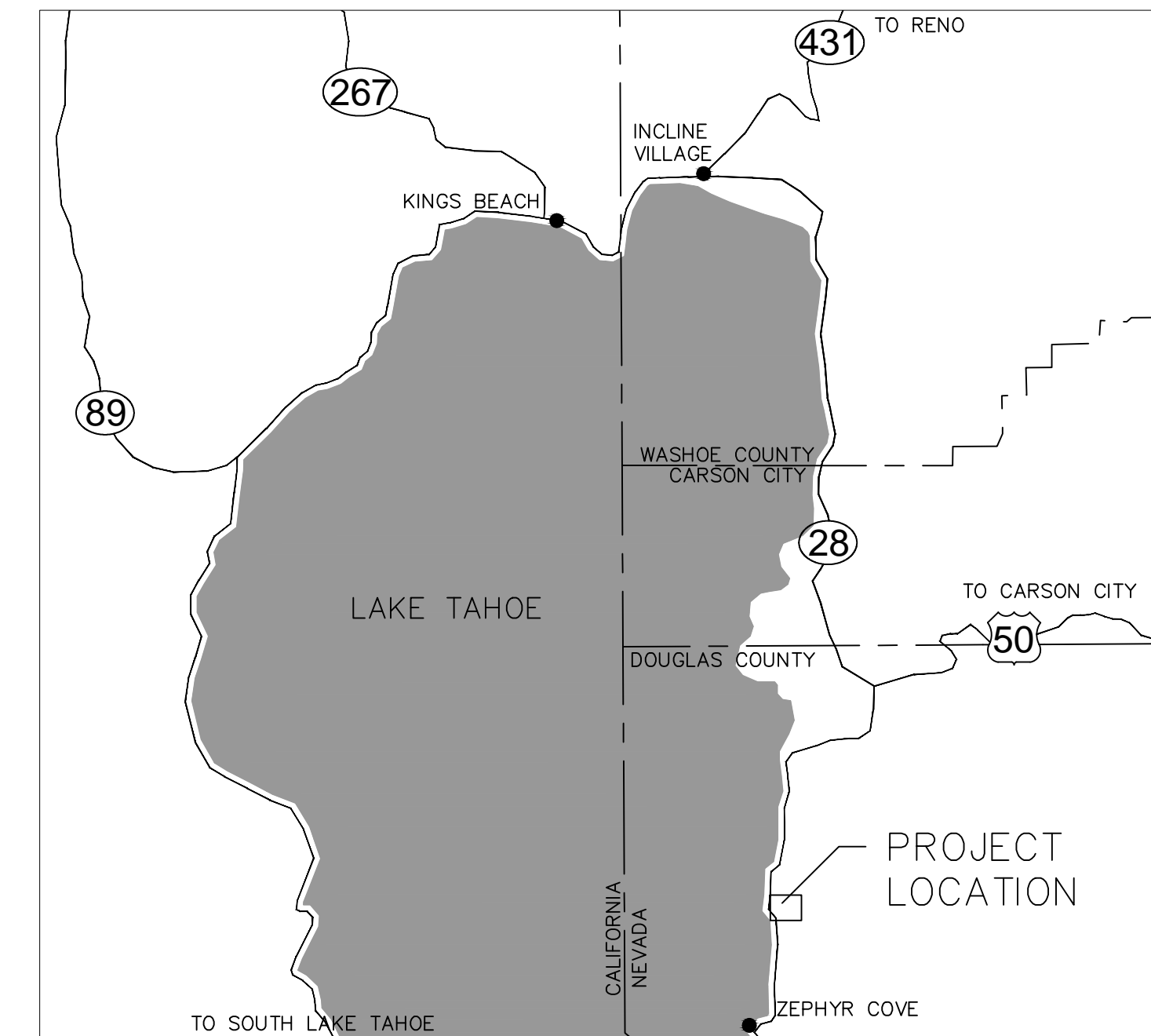

VICINITY MAP

NOT TO SCALE

SHEET INDEX

SHEET TITLE	SHEET NO.
TITLE	i
GENERAL NOTES	ii
EXISTING/DEMOLITION PLAN	C-1
PLAN OVERVIEW	C-2
SECTIONS AND DETAILS	C-3
BID ALTERNATE	C-4
DETAILS	D-1

ASSET OWNER

CAVE ROCK GENERAL IMPROVEMENT DISTRICT
P.O. BOX 10426
ZEPHYR COVE, NV 89448

ENGINEER:

Meghan C. Kelly
MEGHAN C. KELLY, P.E.
REGISTERED CIVIL ENGINEER
STATE OF NEVADA, NO. 20851
NEVADA TAHOE CONSERVATION DISTRICT
400 DORLA CT.
ZEPHYR COVE, NV 89448
(775) 586-1610

7/11/2014
DATE



APPROVAL:

ERIK NILSSEN, P.E.
DOUGLAS COUNTY ENGINEER

DATE

CAVE ROCK ESTATES STORMWATER SYSTEM
RETROFIT PROJECT

BAR IS ONE INCH ON ORIGINAL DRAWING, ADJUST SCALES FOR REDUCED PLOTS

0" = 1"

DESIGNED/DRAWN
MCK/MCK
CHECKED
MCK
DATE
6/2014
SCALE
AS SHOWN

PROJECT
CAVE ROCK
RETROFIT

SHEET

i

1 OF 7

GENERAL NOTES

- IT IS THE RESPONSIBILITY OF THE CONTRACTOR AND HIS SUBCONTRACTOR(S) TO EXAMINE THE PROJECT SITE PRIOR TO THE OPENING OF BID PROPOSALS. THE CONTRACTOR SHALL BECOME FAMILIAR WITH THE CONDITIONS UNDER WHICH THE WORK IS TO BE PERFORMED, SUCH AS THE NATURE AND LOCATION OF THE WORK AND THE GENERAL AND LOCAL CONDITIONS, PARTICULARLY THOSE AFFECTING THE AVAILABILITY OF TRANSPORTATION, THE DISPOSAL, HANDLING, AND STORAGE OF MATERIALS, AVAILABILITY OF LABOR, WATER, ELECTRICITY, ROADS, THE UNCERTAINTIES OF WEATHER, THE CONDITIONS OF THE GROUND, SURFACE AND SUBSURFACE MATERIALS, THE EQUIPMENT AND FACILITIES NEEDED PRIMARILY FOR AND DURING THE PERFORMANCE OF THE WORK, AND THE COSTS THEREOF. ANY FAILURE BY THE CONTRACTOR AND SUBCONTRACTOR(S) TO ACQUAINT HIMSELF WITH ALL THE AVAILABLE INFORMATION WILL NOT RELIEVE HIM FROM RESPONSIBILITY FOR PROPERLY ESTIMATING THE DIFFICULTY AND COST OF SUCCESSFULLY PERFORMING THE WORK.
- NTCD WILL FURNISH ONE SET OF CONSTRUCTION STAKES AS SET FORTH IN THE SPECIAL PROVISIONS.
- CONTRACTOR SHALL MAINTAIN A SET OF PLANS ON SITE SHOWING "AS CONSTRUCTED" CHANGES. UPON COMPLETION, CONTRACTOR SHALL SUPPLY DOUGLAS COUNTY, CREGID, AND NTCD A SET OF "AS BUILT" PLANS.
- MOBILIZATION AREAS ARE TO BE SECURED BY THE CONTRACTOR AND APPROVED BY TRPA. THE CONTRACTOR SHALL BE RESPONSIBLE FOR MAINTENANCE OF MOBILIZATION SITES, INCLUDING PLACEMENT AND MAINTENANCE OF BMP'S.
- PRIOR TO STARTING WORK, THE CONTRACTOR SHALL INSTALL TEMPORARY BMP MEASURES AT LOCATIONS WHERE NEEDED TO CONTROL EROSION AND WATER POLLUTION DURING THE CONSTRUCTION OF THE PROJECT. THE BMP MEASURES SHALL REMAIN IN PLACE AND SHALL BE MAINTAINED IN A FUNCTIONAL CONDITION FOR THE DURATION OF THE CONSTRUCTION. SILT FENCE IS REQUIRED AT ALL CROSS DRAIN OUTLETS. SILT FENCE OR SEDIMENT LOGS WILL BE REQUIRED AT OTHER LOCATIONS AS SHOWN ON THE DRAWINGS OR STAKED IN THE FIELD BY THE ENGINEER. ALL EROSION CONTROL MEASURES SHALL MEET OR EXCEED TRPA REQUIREMENTS.
- ALL EXISTING VEGETATION SHALL BE PRESERVED UNLESS SPECIFICALLY IDENTIFIED BY THE ENGINEER FOR REMOVAL. ALL SHRUBS SHALL BE REMOVED FROM WITHIN THE EXISTING SAND FILTER PER ENGINEER'S DIRECTION. BMP'S TO PROTECT VEGETATION SHALL BE INSTALLED BY THE CONTRACTOR IF REQUIRED BY TRPA.
- UTILITY LOCATIONS SHOWN ON THE DRAWINGS ARE APPROXIMATE. WHERE EXCAVATION IS NECESSARY, THE CONTRACTOR SHALL CONTACT UNDERGROUND SERVICE ALERT (USA) AND ALL AFFECTED UTILITY COMPANIES TO LOCATE ALL BURIED UTILITIES AT LEAST 48 HOURS PRIOR TO EXCAVATION. THE CONTRACTOR SHALL COORDINATE WITH UTILITY COMPANIES FOR RELOCATION OF UTILITIES AS REQUIRED BY THE WORK. THE UTILITY COMPANIES WILL PERFORM ALL RELOCATION WORK AT NO COST TO THE CONTRACTOR, PROVIDED THAT NO CONTRACTOR CAUSED DAMAGE TO UTILITIES HAS OCCURRED DUE TO CONTRACTOR NEGLIGENCE. EXISTING STORM DRAIN LOCATIONS, MATERIALS AND SIZE ARE BASED ON A GROUND SURVEY AND PREVIOUS PROJECT PLAN SETS. WHENEVER CONNECTIONS TO OR CLEARANCE FROM STORM DRAIN PIPE IS REQUIRED, THE CONTRACTOR SHALL POTHOLE TO VERIFY THE LOCATION, SIZE AND MATERIAL OF THE PIPE PRIOR TO CONSTRUCTION.
- ASPHALT REPLACEMENT SHALL INCORPORATE A 4% ±1% CROSS SLOPE BETWEEN THE SAWCUT AND THE NEW ROADSIDE TREATMENT. NEW ROADSIDE FLOW CONVEYANCES SHALL INCORPORATE SUCH GRADE AS NECESSARY TO GUARANTEE WATER CONTINUES TO FLOW IN THE PRESENT DIRECTION, WITHOUT PONDING OR BREAKOUTS.
- ALL WORK SHALL BE DONE WITHIN THE DOUGLAS COUNTY OR CREGID PROPERTY UNLESS EASEMENT OR CONSTRUCTION PERMIT HAS BEEN ACQUIRED BY NTCD, IN WHICH CASE THE LIMITS OF WORK ARE AS SPECIFIED ON THE DRAWINGS. ANY DAMAGE DONE BY THE CONTRACTOR OR HIS SUBCONTRACTORS TO PRIVATE PROPERTY AND/OR OUTSIDE OF THE NOTED LIMITS OF WORK IS SOLELY THE RESPONSIBILITY OF THE CONTRACTOR AND/OR HIS SUBCONTRACTORS.
- NTCD WILL PROVIDE INITIAL TESTING AND INSPECTION OF WORK AND MATERIAL WHEN REQUIRED. THE COST OF TESTING AND INSPECTING THE REMOVAL AND/OR REPLACEMENT OF ANY DEFECTIVE WORK OR MATERIAL IS THE RESPONSIBILITY OF THE CONTRACTOR. SUCH COSTS WILL BE DEDUCTED FROM ANY MONEYS DUE OR WHICH MAY BECOME DUE TO THE CONTRACTOR.
- STANDARD WORK DAYS SHALL BE MONDAY THROUGH FRIDAY. SATURDAY AND SUNDAY MAY BE WORKED ON OCCASION ONLY TO MAKE UP FOR WEATHER DELAYS OR OTHER SCHEDULE DELAYS. NOISE GENERATING ACTIVITIES WILL BE LIMITED TO THE HOURS OF 8:00 AM TO 6:30 PM.
- NOISE SHALL BE REDUCED BY THE MANDATORY USE OF MUFFLERS ON ALL CONSTRUCTION VEHICLES AND EQUIPMENT. WHERE FEASIBLE, SOLENOIDAL PAVEMENT BREAKERS WILL BE USED IN LIEU OF AIR POWERED JACK HAMMERS. NOISE GENERATING ACTIVITIES WILL BE LIMITED TO THE HOURS OF 8:00 AM TO 6:30 PM.
- THE CONTRACTOR SHALL PROVIDE A WATER TRUCK TO WATER AREAS AS NECESSARY TO CONTROL DUST. THE CONTRACTOR SHALL SWEEP THE PAVEMENT AT THE END OF EACH DAY.
- ALL DISTURBED AREAS SHALL BE REVEGETATED WITH NATIVE SPECIES PER TRPA BEST MANAGEMENT PRACTICES (BMP). EXISTING VEGETATION REMOVED DURING CONSTRUCTION SHALL BE CHIPPED AND STORED FOR REVEGETATION.
- ALL TREES AND NATURAL VEGETATION TO REMAIN ON THE SITE SHALL BE PROTECTED PER TRPA.
- SOIL AND CONSTRUCTION MATERIAL SHALL NOT BE TRACKED OFF THE CONSTRUCTION SITE. GRADING OPERATIONS SHALL CEASE IN THE EVENT THAT A DANGER OF VIOLATING THIS CONDITION EXISTS.
- DURING CONSTRUCTION ENVIRONMENTAL PROTECTION DEVICES, SUCH AS EROSION CONTROL, DUST CONTROL, AND VEGETATION PROTECTION DEVICES SHALL BE MAINTAINED AT ALL TIMES.
- LOOSE SOIL MOUNDS OR SURFACES SHALL BE PROTECTED FROM WIND OR WATER EROSION BY BEING APPROPRIATELY COVERED WHEN CONSTRUCTION IS NOT IN ACTIVE PROGRESS OR WHEN REQUIRED BY TRPA.
- EXCAVATED MATERIAL SHALL BE STORED UPGRADE FROM THE EXCAVATED AREA WHENEVER POSSIBLE. NO MATERIAL SHALL BE STORED IN ANY STREAM ENVIRONMENT ZONE (SEZ) OR WET AREA.
- ONLY EQUIPMENT OF A SIZE AND TYPE THAT WILL DO THE LEAST AMOUNT OF DAMAGE, UNDER PREVAILING SITE CONDITIONS, AND CONSIDERING THE NATURE OF THE WORK TO BE PERFORMED, WILL BE USED. ALL HEAVY MACHINERY WORK SHALL BE PERFORMED FROM PAVED SURFACES TO AVOID SOIL COMPACTION.
- NO WASHING OF VEHICLES OR HEAVY EQUIPMENT, INCLUDING CEMENT MIXERS, SHALL BE PERMITTED ANYWHERE ON THE SUBJECT PROPERTY UNLESS AUTHORIZED BY TRPA IN WRITING.
- NO VEHICLE OR HEAVY EQUIPMENT SHALL BE ALLOWED IN A STREAM ENVIRONMENT ZONE OR WET AREA EXCEPT AS AUTHORIZED BY TRPA.
- ALL CONSTRUCTION SHALL BE WINTERIZED BY OCTOBER 15 TO REDUCE THE WATER QUALITY IMPACTS ASSOCIATED WITH WINTER WEATHER.
- THE CONTRACTOR AND/OR THEIR AUTHORIZED AGENTS SHALL EACH DAY REMOVE ALL SEDIMENT, MUD, CONSTRUCTION DEBRIS, OR OTHER POTENTIAL POLLUTANTS THAT MAY HAVE BEEN DISCHARGED TO, OR ACCUMULATE IN, THE DOUGLAS COUNTY RIGHT-OF-WAYS AS A RESULT OF CONSTRUCTION ACTIVITIES ASSOCIATED WITH THIS PROJECT.
- ADDITIONAL CONSTRUCTION SITE DISCHARGE BEST MANAGEMENT PRACTICES MAY BE REQUIRED OF THE OWNER AND HIS OR HER AGENTS DUE TO UNFORESEEN EROSION PROBLEMS.
- TEMPORARY OR PERMANENT STABILIZATION PRACTICES WILL BE INSTALLED ON DISTURBED AREAS AS SOON AS PRACTICABLE AND NO LONGER THEN 24 HOURS AFTER THE CONSTRUCTION ACTIVITY IN THAT PORTION OF THE SITE HAS BEEN TEMPORARILY OR PERMANENTLY CEASED.
- AT A MINIMUM, THE CONTRACTOR OR HIS AGENT SHALL INSPECT ALL DISTURBED AREAS, AREAS USED FOR STORAGE OF MATERIALS AND EQUIPMENT THAT ARE EXPOSED TO PRECIPITATION, VEHICLE ENTRANCE AND EXIT LOCATIONS, AND ALL BMP'S WEEKLY, PRIOR TO A FORECASTED RAIN EVENT AND WITHIN 24 HOURS AFTER ANY ACTUAL RAIN EVENT. SOME EXCEPTIONS TO WEEKLY INSPECTIONS MAY APPLY, SUCH AS FROZEN GROUND CONDITIONS OF SUSPENSION OF LAND DISTURBANCE ACTIVITIES.

ABBREVIATIONS

NOT ALL ABBREVIATIONS LISTED ARE USED IN THESE PLANS

A.B.	AGGREGATE BASE	MDD	MAXIMUM DRY DENSITY
AC.	ACRE	MJ	MECHANICAL JOINT
A.C.	ASPHALT CONCRETE	MI.	MILE
⊕	AT	MIN.	MINIMUM
APPROX.	APPROXIMATE	MISC.	MISCELLANEOUS
AVG.	AVERAGE	N	NOT IN CONTRACT
AWWA	AMERICAN WATER WORKS ASSOCIATION	N.I.C.	NEVADA TAHOE CONSERVATION DISTRICT
BC	BEGIN CURVE	NTCD	NOT TO SCALE
C&G	CURB AND GUTTER	N.T.S.	NUMBER
CATV	CABLE TELEVISION	NO.	ON CENTER
C.B.	CATCH BASIN	OC	ORIGINAL GRADE
CL	CENTERLINE	OG	OVERHEAD ELECTRIC OR TELEPHONE LINES
CLR.	CLEAR	OH(E/T)	PLUS OR MINUS
CONST.	CONSTRUCT	±	POINT
CF	CUBIC FEET	PT.	POINT OF COMPOUND CURVE, PORTLAND CEMENT
CMP	CORRUGATED METAL PIPE	PCC	POINT OF CURVATURE
CREGID	CAVE ROCK ESTATES GENERAL IMPROVEMENT DISTRICT	PC	PROTECT IN PLACE
CSP	CORRUGATED STEEL PIPE	PIP	POLYVINYL CHLORIDE
CY	CUBIC YARD	PVC	PAVEMENT
D.G.	DECOMPOSED GRANITE	PVMT	POINT ON CURVE
DEG	DEGREE(S)	POS	POSITIVE
DI	DROP INLET	PRC	POINT OF REVERSE CURVE
DIA.	DIAMETER	PSI	POUNDS PER SQUARE INCH
DR	DIMENSION RATIO	PL	PROPERTY LINE
DWG	DRAWING	PO	PUSH ON
DW, DWY	DRIVEWAY	PUE	PUBLIC UTILITY EASEMENT
EA.	EACH	R	RADIUS
EASE.	EASEMENT	RCP	REINFORCED CONCRETE PIPE
EG	EXISTING GRADE	REVEG	REVEGETATION
ELEC	ELECTRIC	RT,R	RIGHT
EP	EDGE OF PAVEMENT	R/W, ROW	RIGHT-OF-WAY
ELEV.	ELEVATION	SS	SANITARY SEWER, STAINLESS STEEL
EC	END CURVE	SSCO	SANITARY SEWER CLEAN OUT
EX.	EXISTING	SSMH	SANITARY SEWER MANHOLE
FG	FINISH GRADE	S	SLOPE
FH	FIRE HYDRANT	S	SOUTH
FCA	FLANGE COUPLER ADAPTER	SF	SQUARE FOOT/FEET
FES	FLARED END SECTION (METAL)	SHT	SHEET
FL	FLOWLINE	STD	STANDARD
FLG	FLANGED	SDR	STANDARD DIMENSION RATIO
FT.	FOOT, FEET	SSPWC	STANDARD SPECIFICATIONS FOR PUBLIC WORKS CONSTRUCTION
FTG	FOOTING	STA	STATION
FV	FLUSH VALVE	SD	STORM DRAIN
·	DEGREE	SDMH	STORM DRAIN MANHOLE
G	GAS	TBC	TOP BACK OF CURB
GV	GATE VALVE	TOC	TOP OF CURB
GB	GRADE BREAK	TRPA	TAHOE REGIONAL PLANNING AGENCY
HDPE	HIGH DENSITY POLYETHYLENE	TW	TOP OF WALL
HDPE-NP	NON-PERFORATED HIGH DENSITY POLYETHYLENE	TYP	TYPICAL
HDPE-P	PERFORATED HIGH DENSITY POLYETHYLENE	UGE	UNDERGROUND ELECTRIC LINES
HP	HIGH POINT	UGT	UNDERGROUND TELEPHONE LINES
HOR., HORIZ.	HORIZONTAL	VC	VERTICAL CURVE
IN.	INCH	VG	VALLEY GUTTER
IE	INVERT ELEVATION	VPC	VERTICAL POINT OF CURVATURE
IRR.	IRRIGATION	VPI	VERTICAL POINT OF INFLECTION
L	LEFT	VPT	VERTICAL POINT OF TANGENT
LEN.	LENGTH	W	WATER
LF	LINEAR FEET	WL	WATERLINE
LID	LOW IMPACT DEVELOPMENT	W	WEST
LP	LOW POINT	W/	WITH
LS	LUMP SUM	WM	WATER METER
MH	MANHOLE		
MAX.	MAXIMUM		

UTILITIES

CABLE TELEVISION	CHARTER COMMUNICATIONS, (775) 588-1077
NATURAL GAS	SOUTHWEST GAS, (877) 860-6022
ELECTRIC	NV ENERGY, (775) 834-4444
WATER	CAVE ROCK/SKYLAND WATER SYSTEM, (775) 782-9989
STORM DRAIN	CAVE ROCK ESTATES GID, (775)588-2944
SEWER	TAHOE DOUGLAS DISTRICT, (775) 588-5641
PHONE	FRONTIER, (775) 782-0966
USA DIGS	(800) 642-2444 OR 811

HORIZONTAL AND VERTICAL PROJECTION

VERTICAL CONTROL IS NAVD88, Geoid09; HORIZONTAL CONTROL IS NEVADA STATE PLANE, NAD 83, WEST ZONE (U.S. FEET)

LEGEND

NOTE: LEGENDS PROVIDED ON INDIVIDUAL PLAN SHEETS OVERRIDES THIS LEGEND

EXISTING	PROPOSED
MAJOR CONTOUR	VEGETATION REMOVAL
MINOR CONTOUR	AC PAVEMENT
PROPERTY LINE	ALIGNMENT
DIRT PARKING	LIMITS OF DISTURBANCE
EDGE OF PAVEMENT	FINISHED GRADE (SECTION VIEW)
GAS LINE	ROCK
WATER LINE	CONSTRUCTION LIMIT FENCE
WATER METER/ VALVE	FILTER FENCE OR COIR LOGS
SANITARY SEWER LINE	RIP RAP/ROCK SLOPE PROTECTION
SANITARY SEWER MANHOLE	FIRE HYDRANT
UNDERGROUND ELECTRIC LINE	AC PAVEMENT REMOVAL
TELEPHONE OR CABLE LINE	CONCRETE
STORM DRAIN	WASHOE SEPTIC SAND
TREE	
CONCRETE	
EXISTING GRADE (SECTION VIEW)	
CONTROL POINT	
BUILDING	
ROCK	

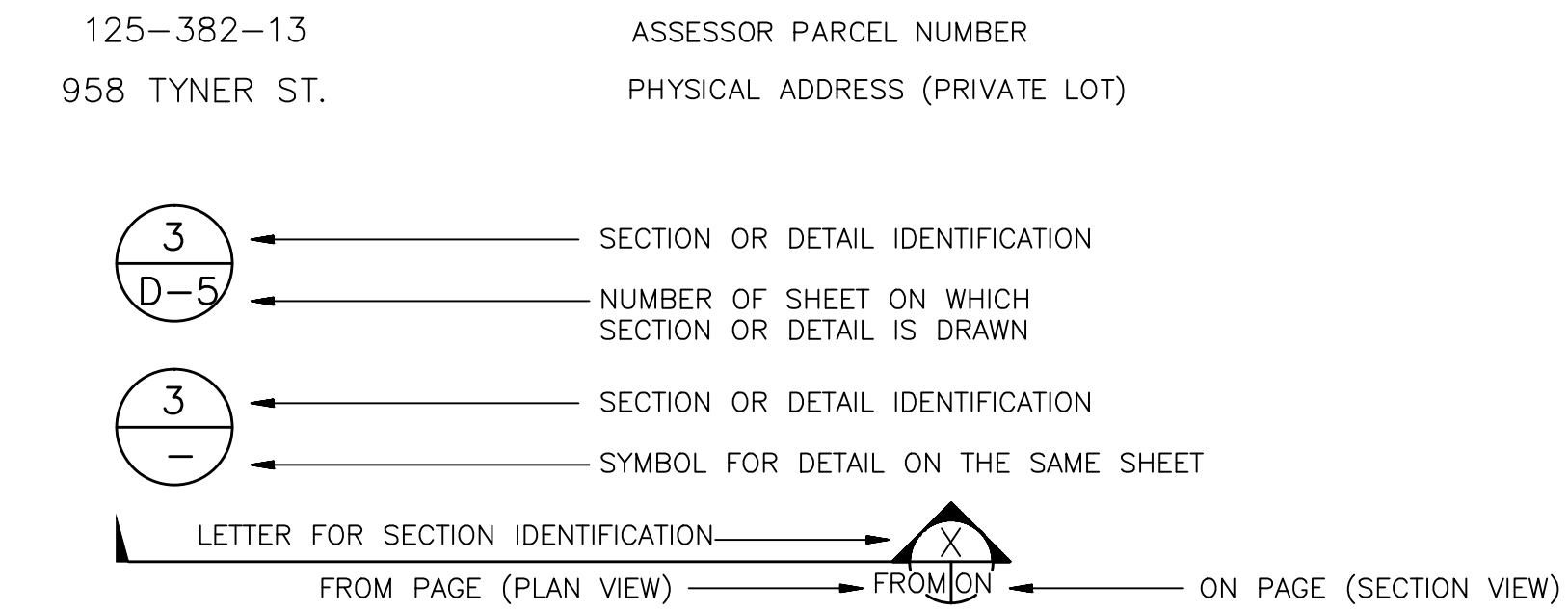

DOUGLAS COUNTY UTILITY DIVISION GENERAL NOTES				
<p>NOTES:</p> <ol style="list-style-type: none"> ALL MATERIAL AND CONSTRUCTION SHALL CONFORM TO THE STANDARD SPECIFICATIONS FOR PUBLIC WORKS CONSTRUCTION. THE CONTRACTOR SHALL VERIFY UTILITY LOCATIONS AND NOTIFY THE RESPECTIVE UTILITY COMPANIES FOR FIELD VERIFICATION PRIOR TO CONSTRUCTION. THE CONTRACTOR SHALL COORDINATE UTILITY REMOVALS, RELOCATIONS OR CONNECTIONS TO UTILITIES WITH THE RESPECTIVE UTILITY. CONTACT UNDERGROUND SERVICE ALERT AT 1-800-227-2600. DURING CONSTRUCTION ON OR NEAR A PUBLIC STREET OR HIGHWAY, THE CONTRACTOR SHALL MAINTAIN TRAFFIC CONTROL CONFORMING TO THE MANUAL ON UNIFORM TRAFFIC CONTROL DEVICES. ALL STORM DRAIN PIPE SHALL BE REINFORCED CONCRETE, CLASS III MINIMUM. PIPE JOINTS SHALL BE RUBBER GASKETED FOR ALL PIPE WITHIN THE PUBLIC ROAD RIGHT-OF-WAY AND ALL ROADWAYS AND TRAVELED WAYS. CONTRACTOR SHALL INSTALL AND MAINTAIN BEST MANAGEMENT PRACTICES UNTIL THE COUNTY ISSUES A NOTICE OF COMPLETION. ALL STORM DRAIN PIPE AND STRUCTURES SHALL BE CLEANED OF SEDIMENT AND DEBRIS. 				
<p>1. ALL WORK SHALL CONFORM TO THE STANDARD SPECIFICATIONS AND DETAILS FOR PUBLIC WORKS CONSTRUCTION AS ADOPTED BY DOUGLAS COUNTY. THE OWNER / CONTRACTOR SHALL OBTAIN A PERMIT FROM DOUGLAS COUNTY COMMUNITY DEVELOPMENT PRIOR TO THE START OF CONSTRUCTION.</p> <p>2. ALL TRAFFIC CONTROL AND BARRICADING WITHIN THE PUBLIC RIGHT-OF-WAY SHALL CONFORM TO PART VI OF THE MANUAL ON UNIFORM TRAFFIC CONTROL DEVICES, LATEST EDITION, AND THE NEVADA WORK ZONE TRAFFIC CONTROL HANDBOOK, 1986 EDITION. NO STREET CLOSURES WILL BE ALLOWED WITHOUT PRIOR WRITTEN APPROVAL OF A TRAFFIC CONTROL PLAN BY THE DOUGLAS COUNTY ENGINEERING DIVISION.</p> <p>3. THE OWNER / CONTRACTOR SHALL CALL UNDERGROUND SERVICE ALERT "CALL BEFORE YOU DIG" 1-800-227-2600 FORTY-EIGHT (48) HOURS PRIOR TO START OF CONSTRUCTION.</p> <p>4. THE OWNER / CONTRACTOR SHALL CALL DOUGLAS COUNTY ENGINEERING DIVISION (782-6237) FORTY-EIGHT (48) HOURS PRIOR TO START OF CONSTRUCTION. THE OWNER / CONTRACTOR SHALL CALL TWENTY-FOUR (24) HOURS PRIOR TO REQUIRED INSPECTIONS AND TESTING. THE REQUIRED INSPECTIONS AND TESTING ARE LISTED ON THE INSPECTION RECORD ISSUED WITH EACH PERMIT. THE OWNER / CONTRACTOR MUST HAVE THE PERMIT NUMBER AND THE DESCRIPTION LISTED ON THE INSPECTION RECORD TO SCHEDULE REQUIRED INSPECTIONS AND TESTING.</p> <p>5. THE APPROVED PLAN AND PERMIT MUST BE ON THE JOB SITE AT ALL TIMES.</p>				
NO.	REVISION	DATE	STANDARD DETAIL FOR PUBLIC WORKS CONSTRUCTION	SECTION DOUGLAS COUNTY
				DATE: 6/07/2007
				DWG: DC D13
NO.	REVISION	DATE	STANDARD DETAIL FOR PUBLIC WORKS CONSTRUCTION	SECTION DOUGLAS COUNTY
				DATE: 6/07/2007
				DWG: DC B28



CAVE ROCK ESTATES STORMWATER SYSTEM RETROFIT PROJECT GENERAL NOTES

BAR IS ONE INCH ON ORIGINAL DRAWING, ADJUST SCALES FOR REDUCED PLOTS



DESIGNED/DRAWN	MCK/MCK
CHECKED	MCK
DATE	6/2014
SCALE	AS SHOWN

PROJECT
CAVE ROCK RETROFIT

SHEET

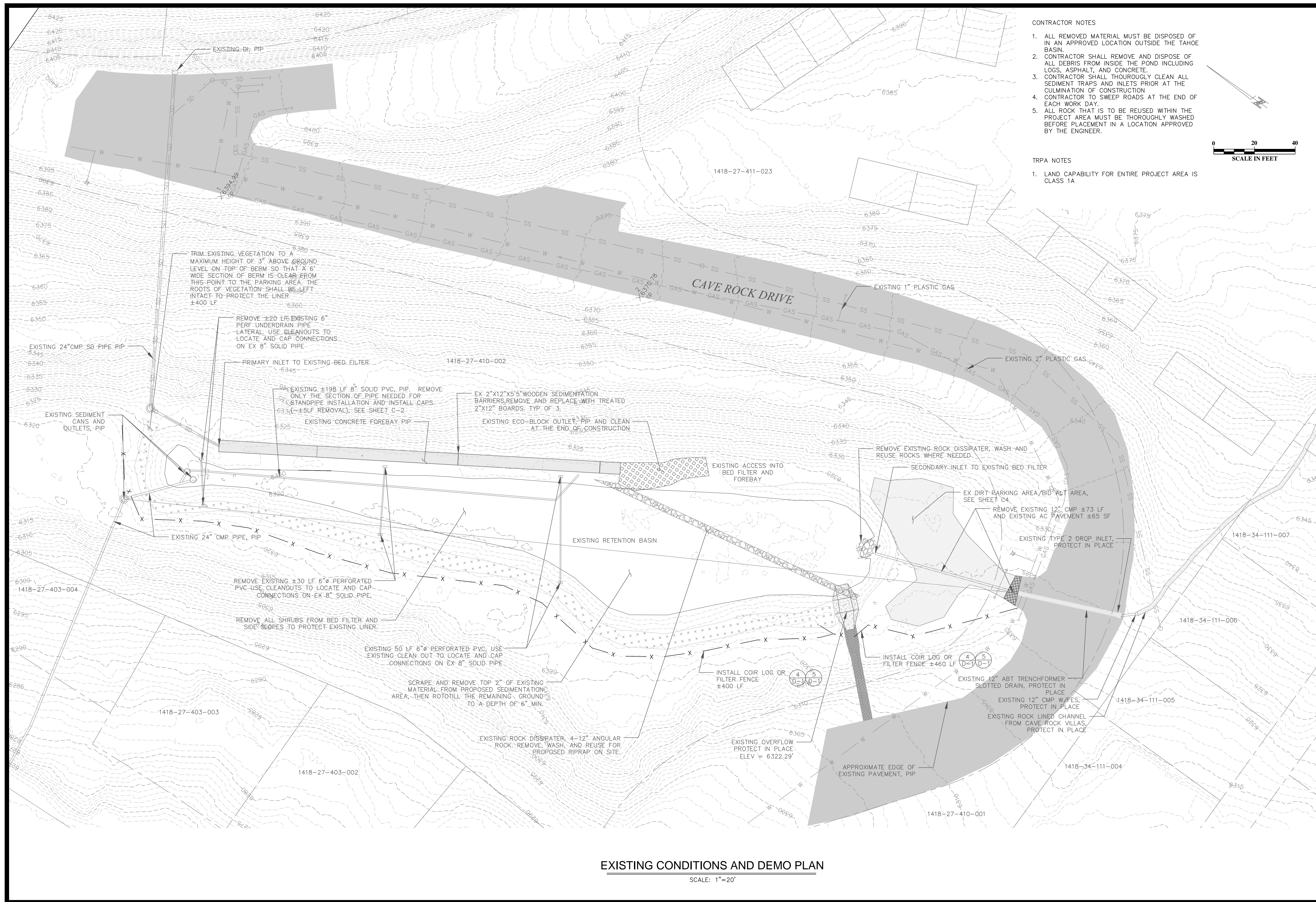

- CONTRACTOR NOTES**
1. ALL REMOVED MATERIAL MUST BE DISPOSED OF IN AN APPROVED LOCATION OUTSIDE THE TAHOE BASIN.
 2. CONTRACTOR SHALL REMOVE AND DISPOSE OF ALL DEBRIS FROM INSIDE THE POND INCLUDING LOGS, ASPHALT, AND CONCRETE.
 3. CONTRACTOR SHALL THOROUGHLY CLEAN ALL SEDIMENT TRAPS AND INLETS PRIOR AT THE CULMINATION OF CONSTRUCTION
 4. CONTRACTOR TO SWEEP ROADS AT THE END OF EACH WORK DAY.
 5. ALL ROCK THAT IS TO BE REUSED WITHIN THE PROJECT AREA MUST BE THOROUGHLY WASHED BEFORE PLACEMENT IN A LOCATION APPROVED BY THE ENGINEER.
- TRPA NOTES**
1. LAND CAPABILITY FOR ENTIRE PROJECT AREA IS CLASS 1A

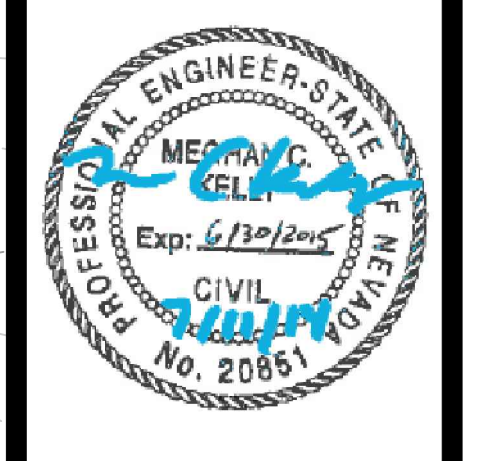
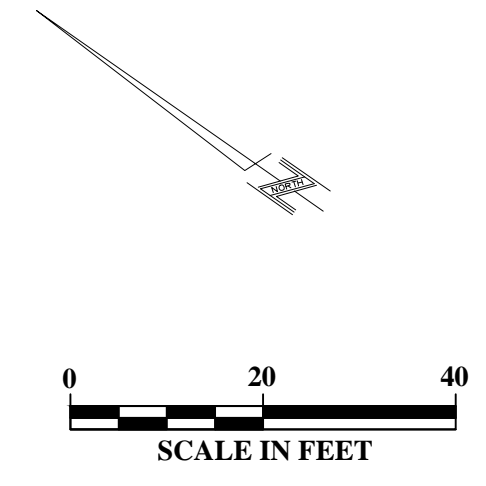

**CAVE ROCK ESTATES STORMWATER SYSTEM
 RETROFIT PROJECT
 EXISTING CONDITIONS AND DEMO PLAN**

BAR IS ONE INCH ON ORIGINAL DRAWING, ADJUST SCALES FOR REDUCED PLOTS

DESIGNED/DRAWN	MCK/MCK
CHECKED	MCK
DATE	6/2014
SCALE	AS SHOWN
PROJECT	CAVE ROCK RETROFIT
SHEET	C-1 3 OF 7

EXISTING CONDITIONS AND DEMO PLAN
 SCALE: 1"=20'

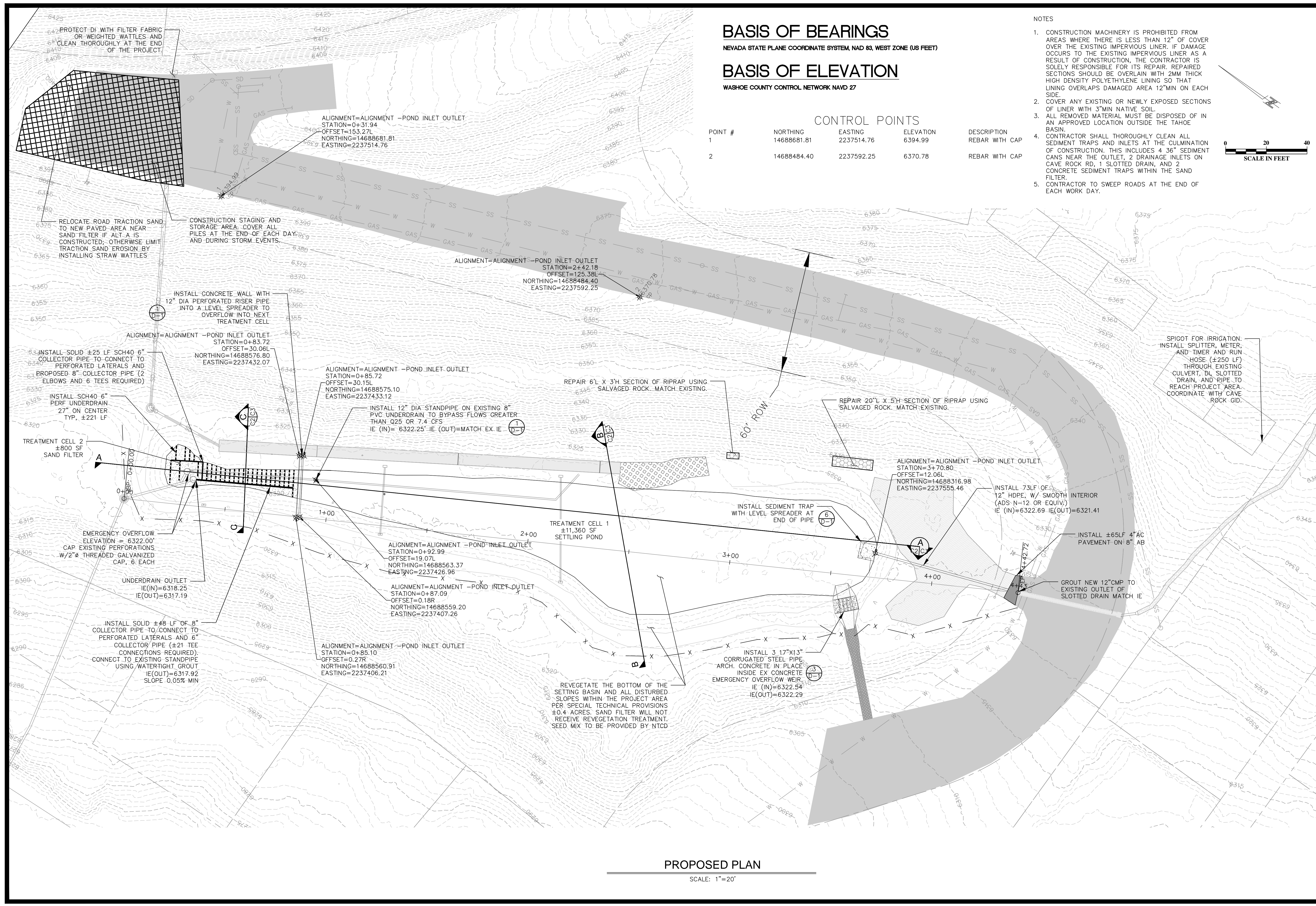

BASIS OF BEARINGS

NEVADA STATE PLANE COORDINATE SYSTEM, NAD 83, WEST ZONE (US FEET)

BASIS OF ELEVATION

WASHOE COUNTY CONTROL NETWORK NAVD 27

CONTROL POINTS

POINT #	NORTHING	EASTING	ELEVATION	DESCRIPTION
1	14688681.81	2237514.76	6394.99	REBAR WITH CAP
2	14688484.40	2237592.25	6370.78	REBAR WITH CAP

NOTES

- CONSTRUCTION MACHINERY IS PROHIBITED FROM AREAS WHERE THERE IS LESS THAN 12" OF COVER OVER THE EXISTING IMPERVIOUS LINER. IF DAMAGE OCCURS TO THE EXISTING IMPERVIOUS LINER AS A RESULT OF CONSTRUCTION, THE CONTRACTOR IS SOLELY RESPONSIBLE FOR ITS REPAIR. REPAIRED SECTIONS SHOULD BE OVERLAIN WITH 2MM THICK HIGH DENSITY POLYETHYLENE LINING SO THAT LINING OVERLAPS DAMAGED AREA 12" MIN ON EACH SIDE.
- COVER ANY EXISTING OR NEWLY EXPOSED SECTIONS OF LINER WITH 3" MIN NATIVE SOIL.
- ALL REMOVED MATERIAL MUST BE DISPOSED OF IN AN APPROVED LOCATION OUTSIDE THE TAHOE BASIN.
- CONTRACTOR SHALL THOROUGHLY CLEAN ALL SEDIMENT TRAPS AND INLETS AT THE CULMINATION OF CONSTRUCTION. THIS INCLUDES 4 36" SEDIMENT CANS NEAR THE OUTLET, 2 DRAINAGE INLETS ON CAVE ROCK RD, 1 SLOTTED DRAIN, AND 2 CONCRETE SEDIMENT TRAPS WITHIN THE SAND FILTER.
- CONTRACTOR TO SWEEP ROADS AT THE END OF EACH WORK DAY.

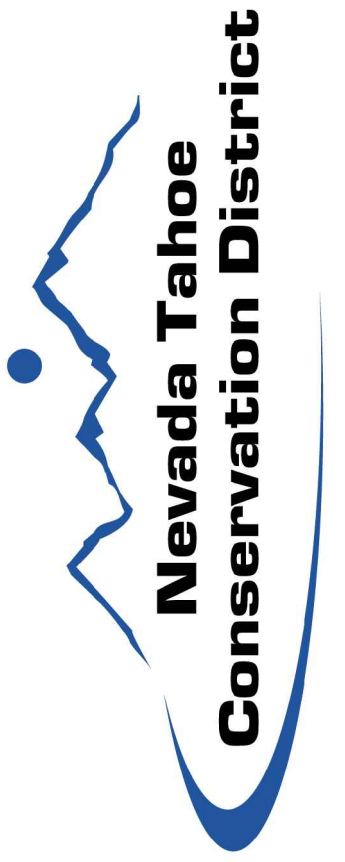
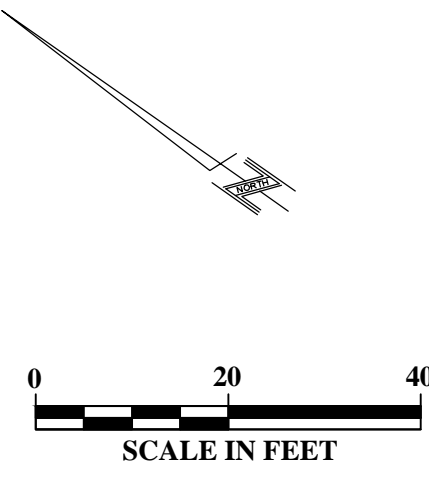

**CAVE ROCK ESTATES STORMWATER SYSTEM
RETROFIT PROJECT
PROPOSED PLAN**

BAR IS ONE INCH ON ORIGINAL DRAWING, ADJUST SCALES FOR REDUCED PLOTS

DESIGNED/DRAWN
MCK/MCK
CHECKED
MCK
DATE
7/2014
SCALE
AS SHOWN

PROJECT
CAVE ROCK
RETROFIT

SHEET
C-2
4 OF 7

PROPOSED PLAN
SCALE: 1"=20'

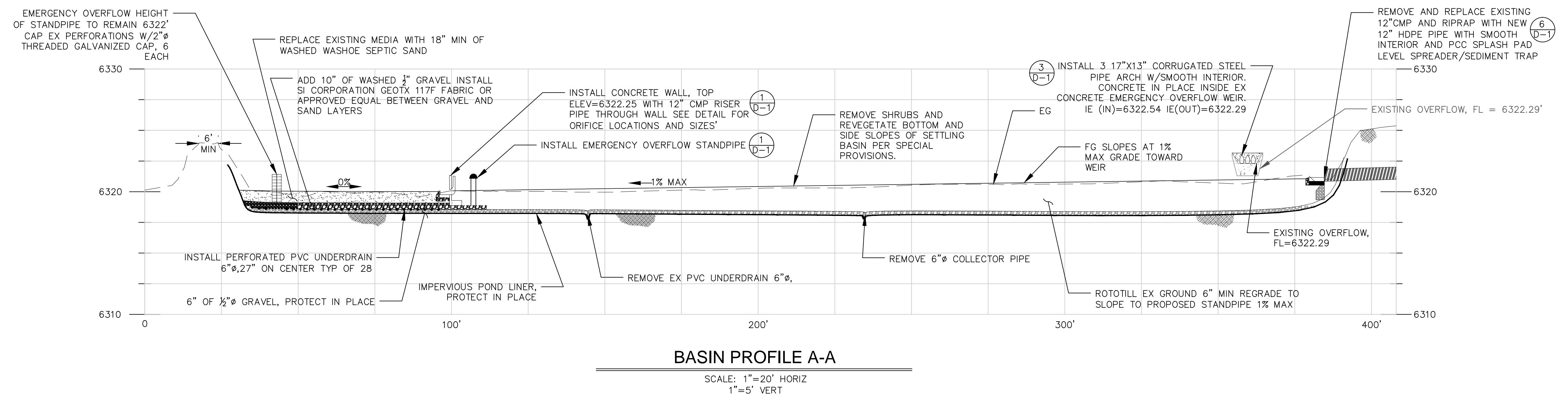

BASIN PROFILE A-A

SCALE: 1"=20' HORIZ
1"=5' VERT

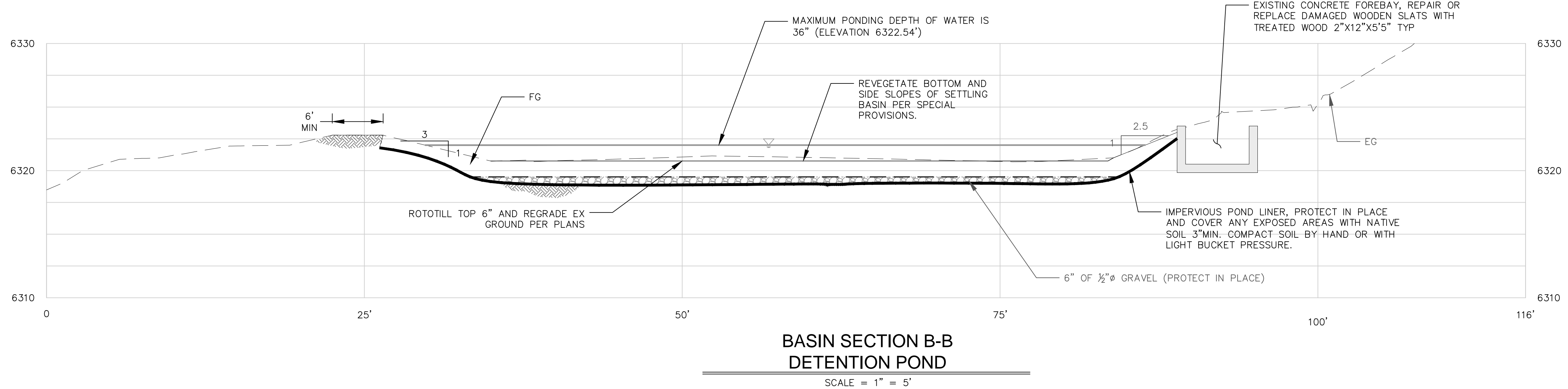

**BASIN SECTION B-B
DETENTION POND**

SCALE = 1" = 5'

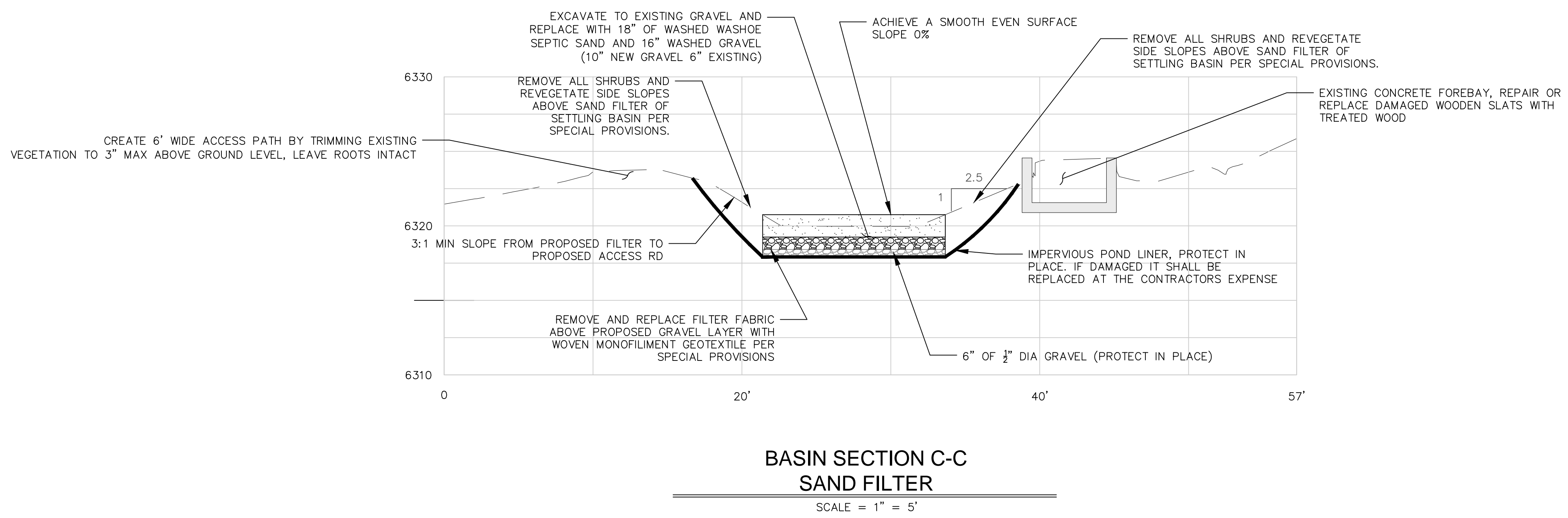

**BASIN SECTION C-C
SAND FILTER**

SCALE = 1" = 5'

NOTES:
1. NO EQUIPMENT IS ALLOWED ON AREAS WHERE LESS THAN 12" OF COVER IS OVER THE EXISTING IMPERVIOUS LINER. IF THE LINER IS PENETRATED, IT IS SOLE RESPONSIBILITY OF THE CONTRACTOR TO REPAIR IT. SEE NOTES ON SHEET C-2 FOR MORE INFORMATION.

BAR IS ONE INCH ON ORIGINAL DRAWING, ADJUST SCALES FOR REDUCED PLOTS



DESIGNED/DRAWN
MCK/MCK
CHECKED
MCK
DATE
7/2014
SCALE
AS SHOWN

PROJECT
CAVE ROCK
RETROFIT

SHEET
C-3
5 OF 7

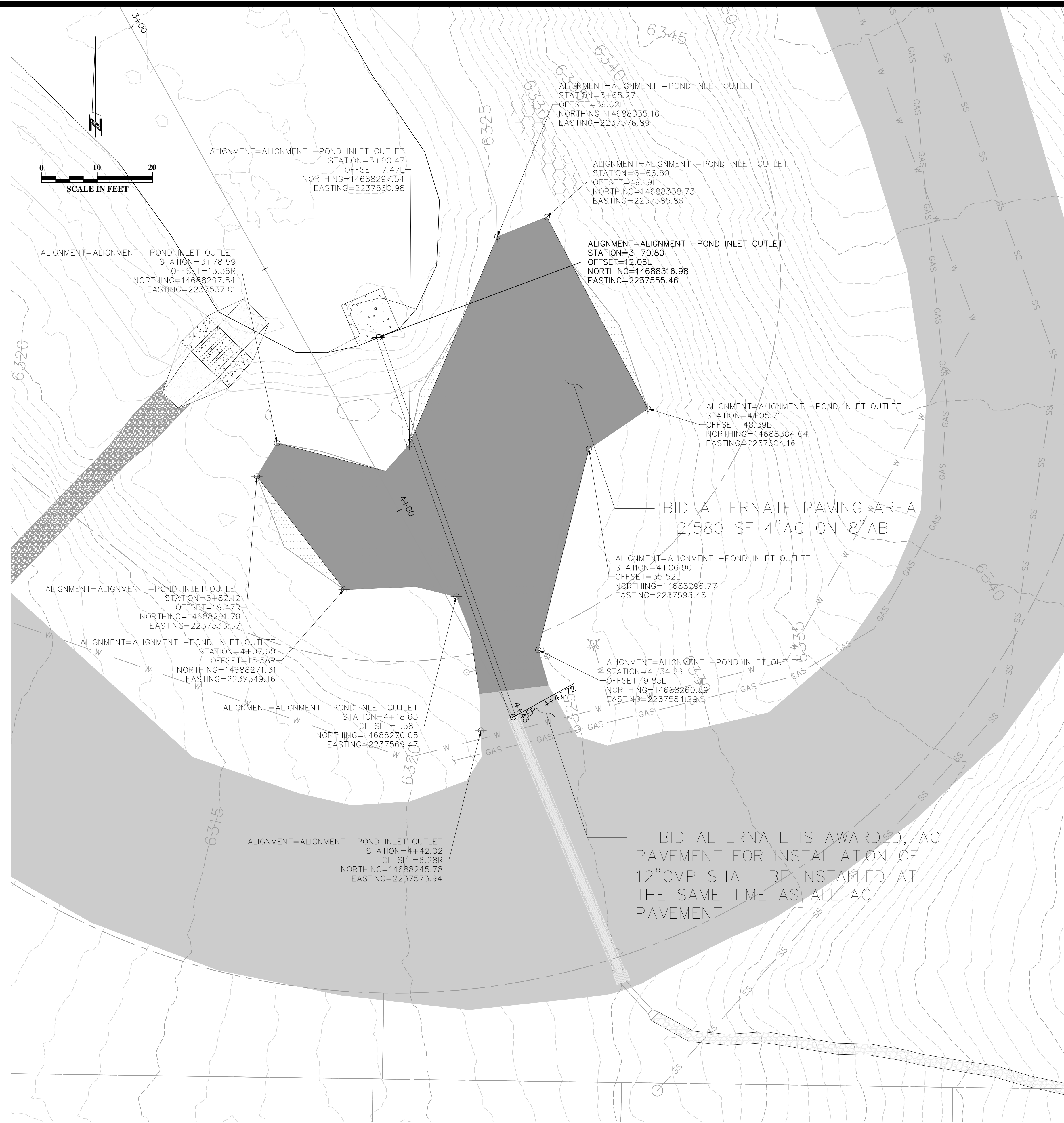

BID ALTERNATE PLAN
SCALE: 1"=10'

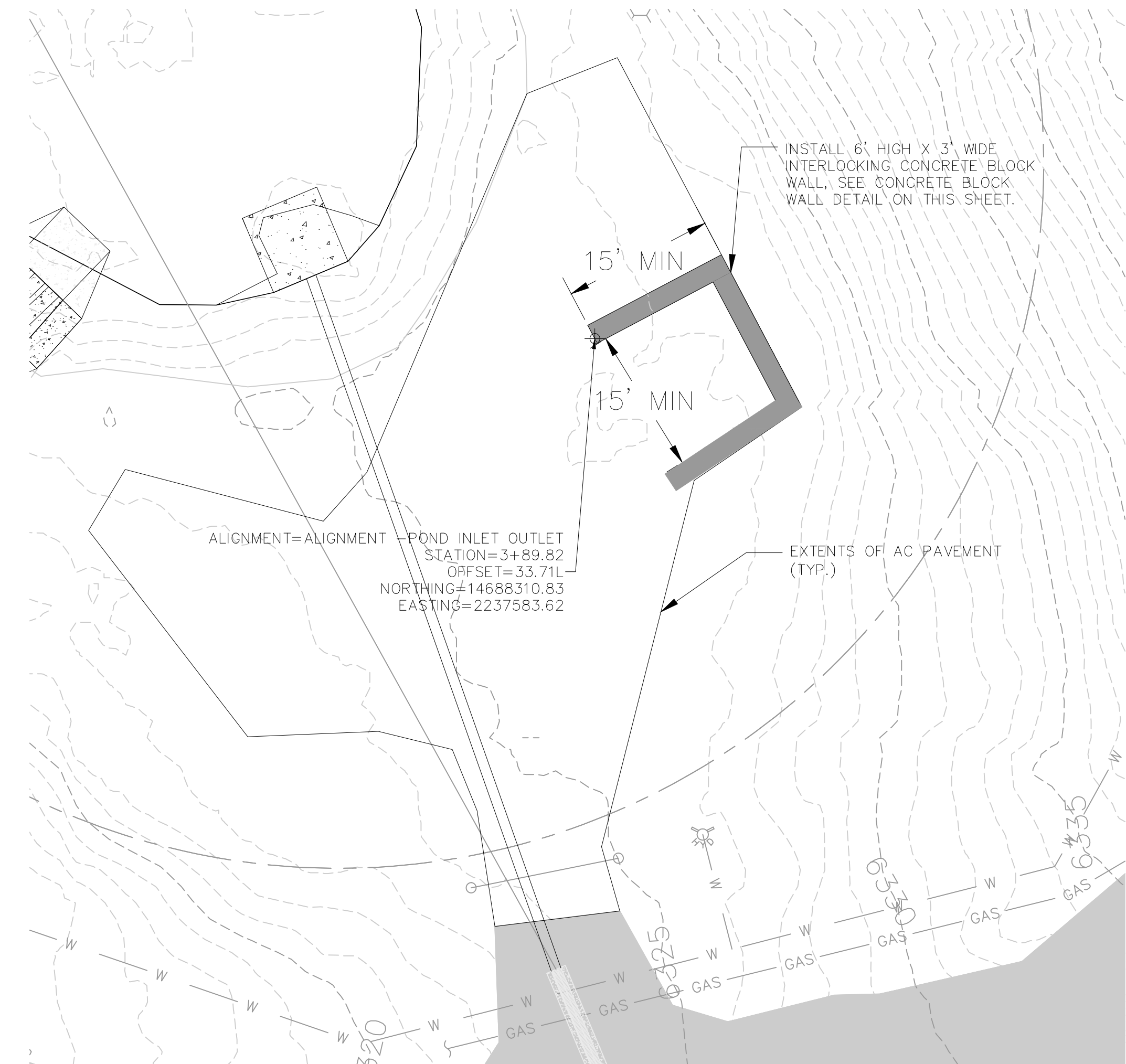

BID ALTERNATE DETAIL
SCALE: 1"=10'

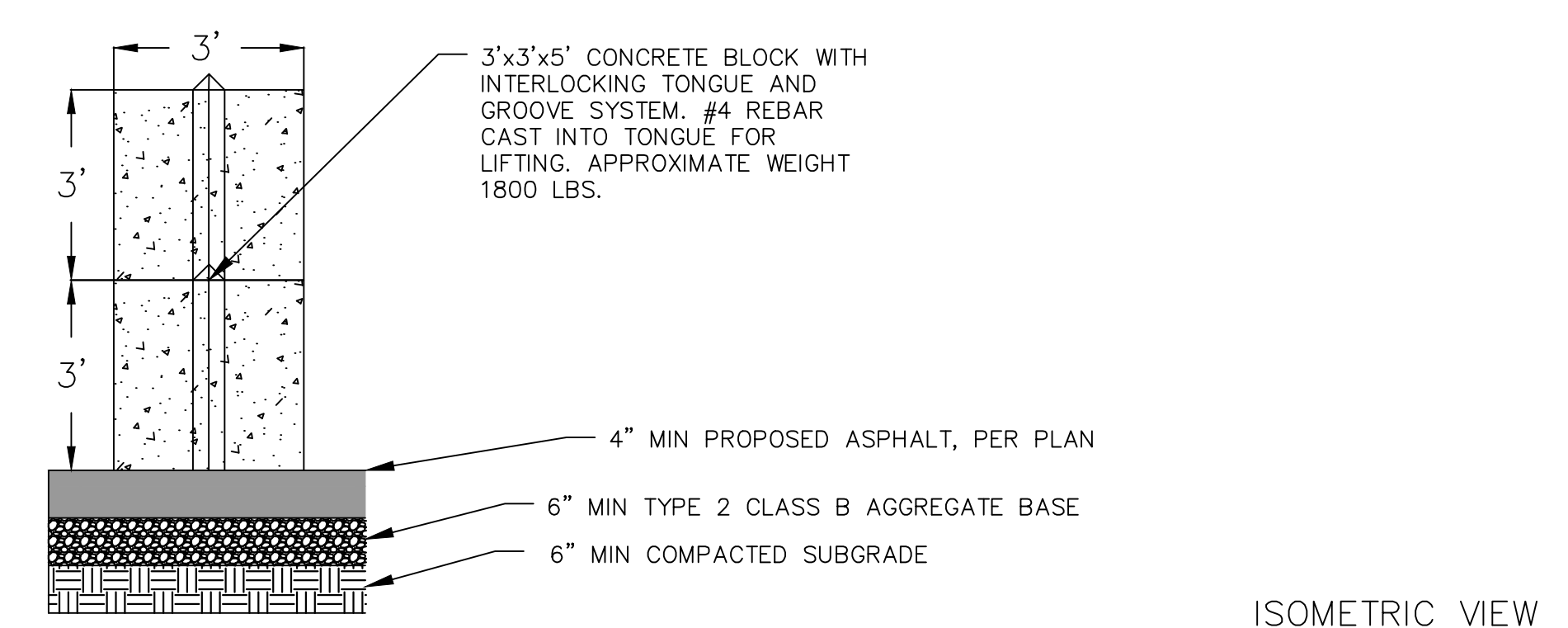

CONCRETE BLOCK WALL DETAIL
SCALE: 1"=10'



**CAVE ROCK ESTATES STORMWATER SYSTEM
RETROFIT PROJECT
BID ALTERNATE**

BAR IS ONE INCH ON ORIGINAL DRAWING, ADJUST SCALES FOR REDUCED PLOTS

DESIGNED/DRAWN	MCK/MCK
CHECKED	MCK
DATE	6/2014
SCALE	AS SHOWN

PROJECT
CAVE ROCK
RETROFIT

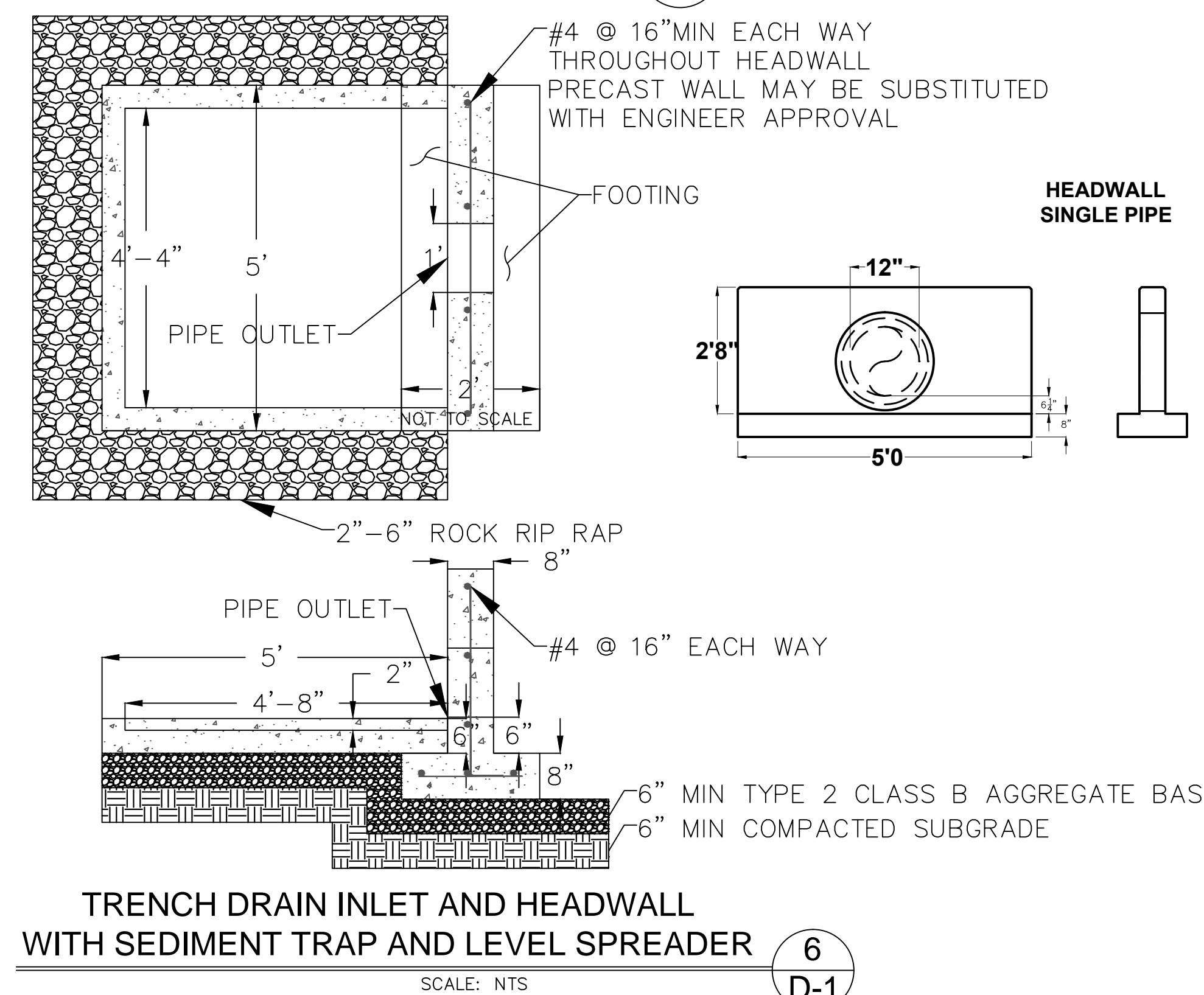
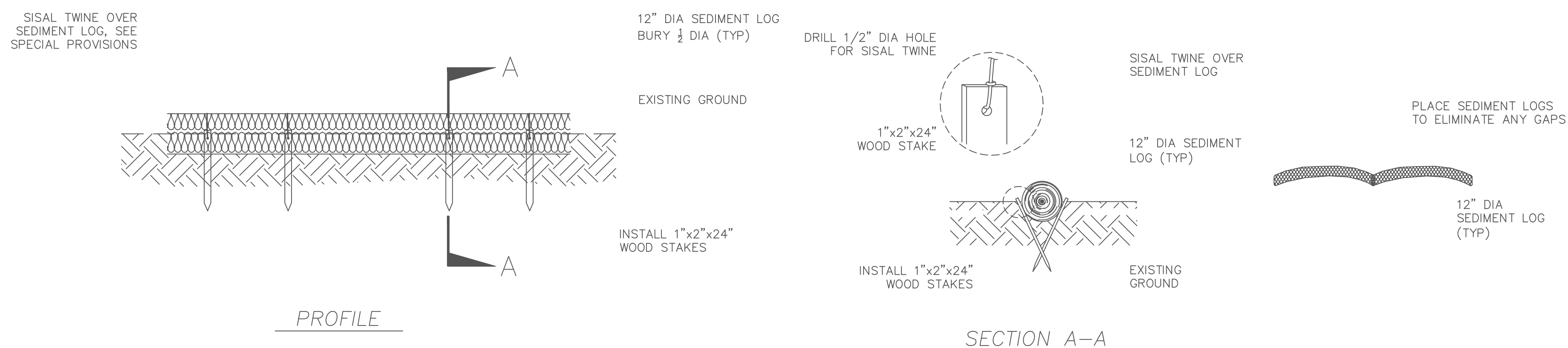
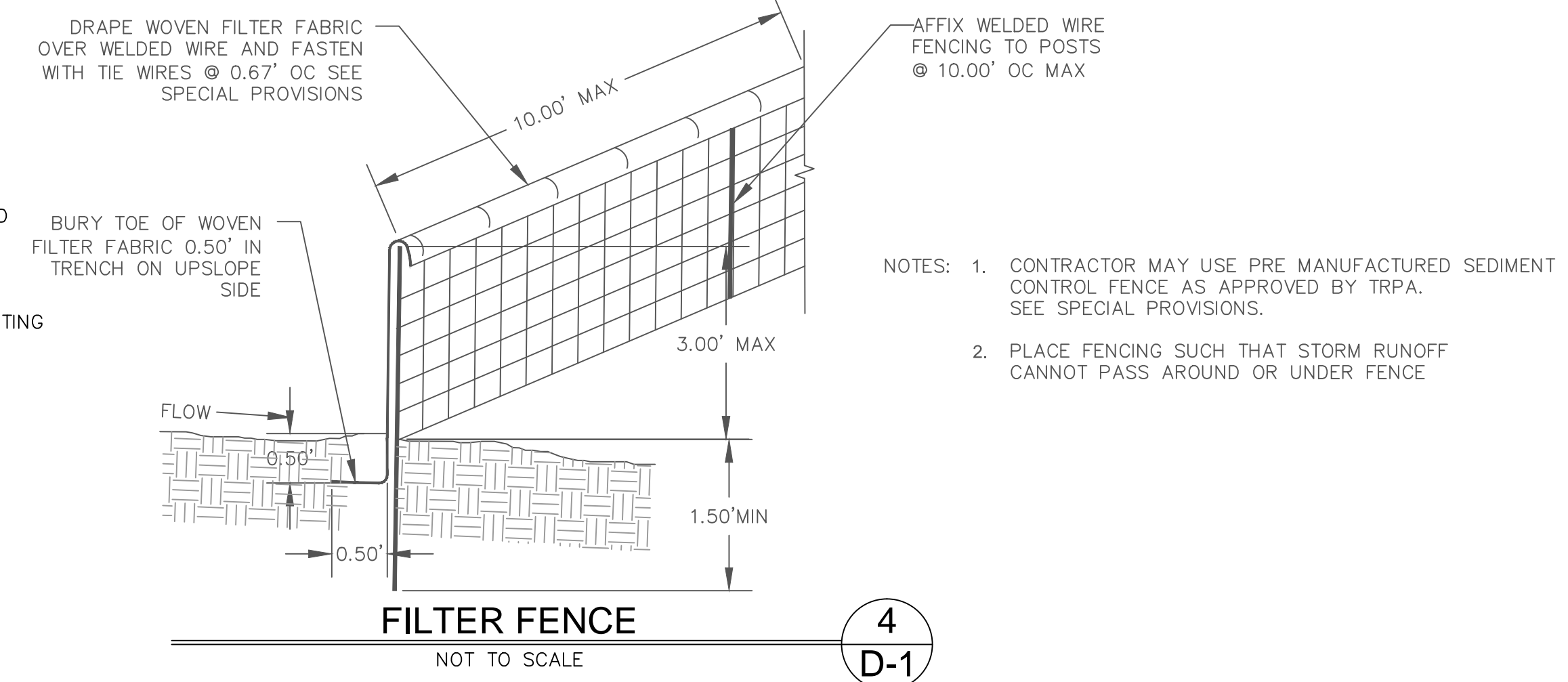
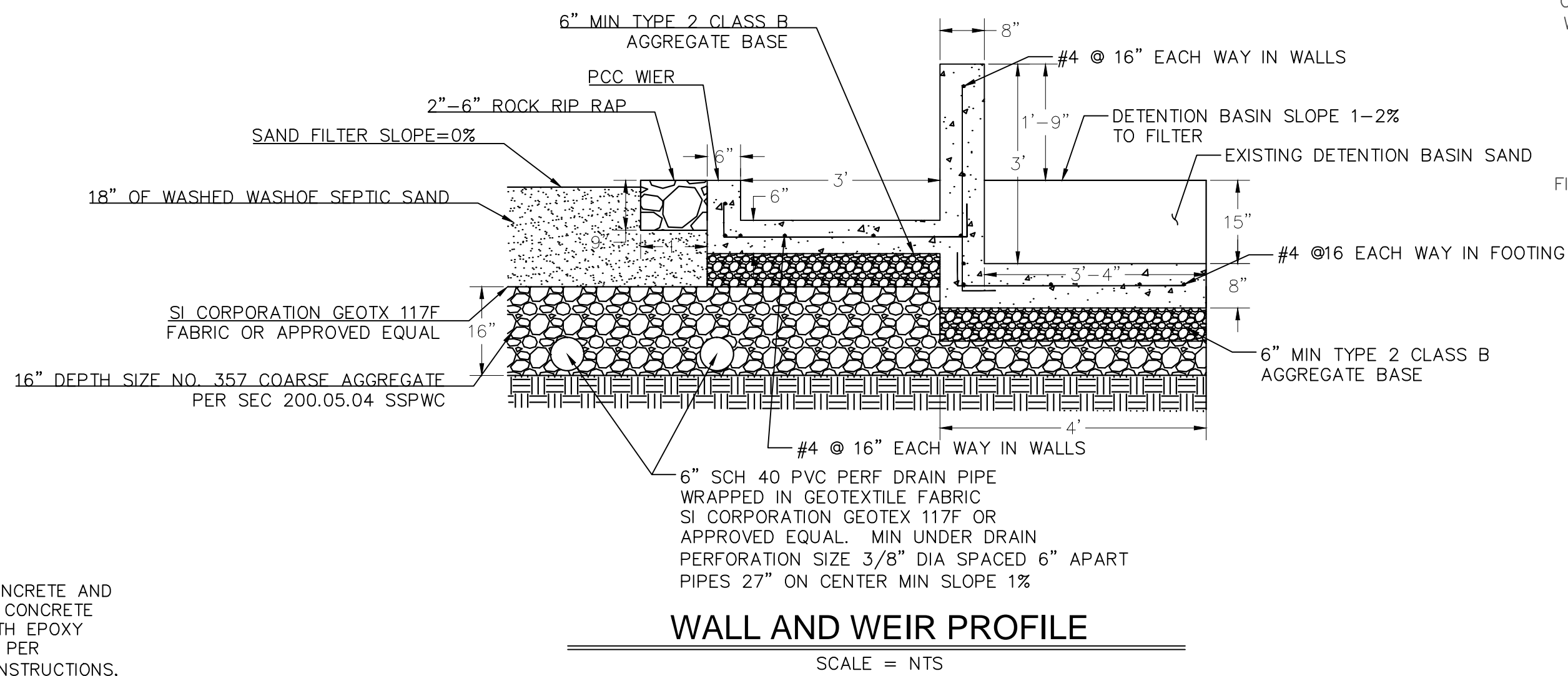
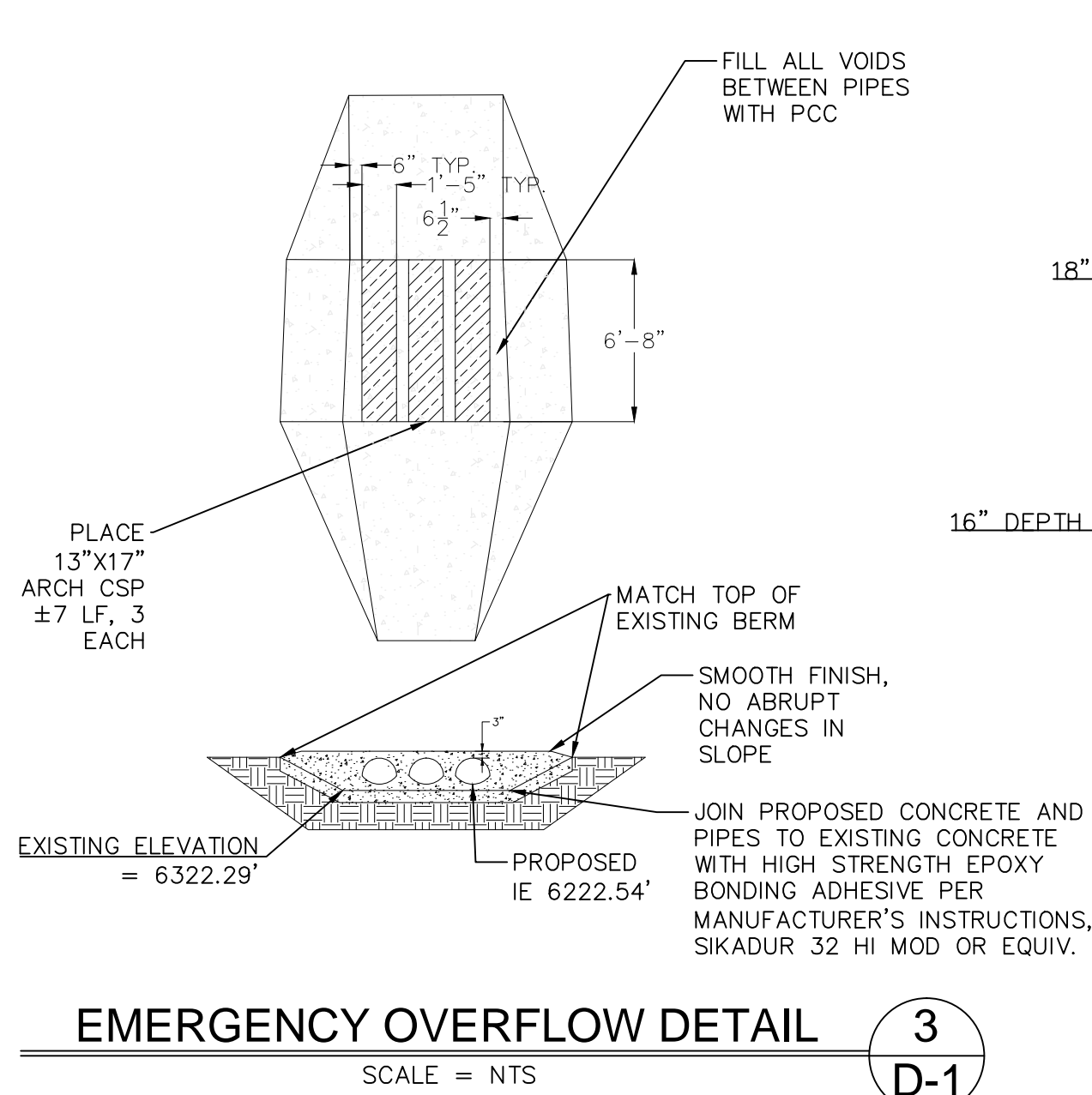
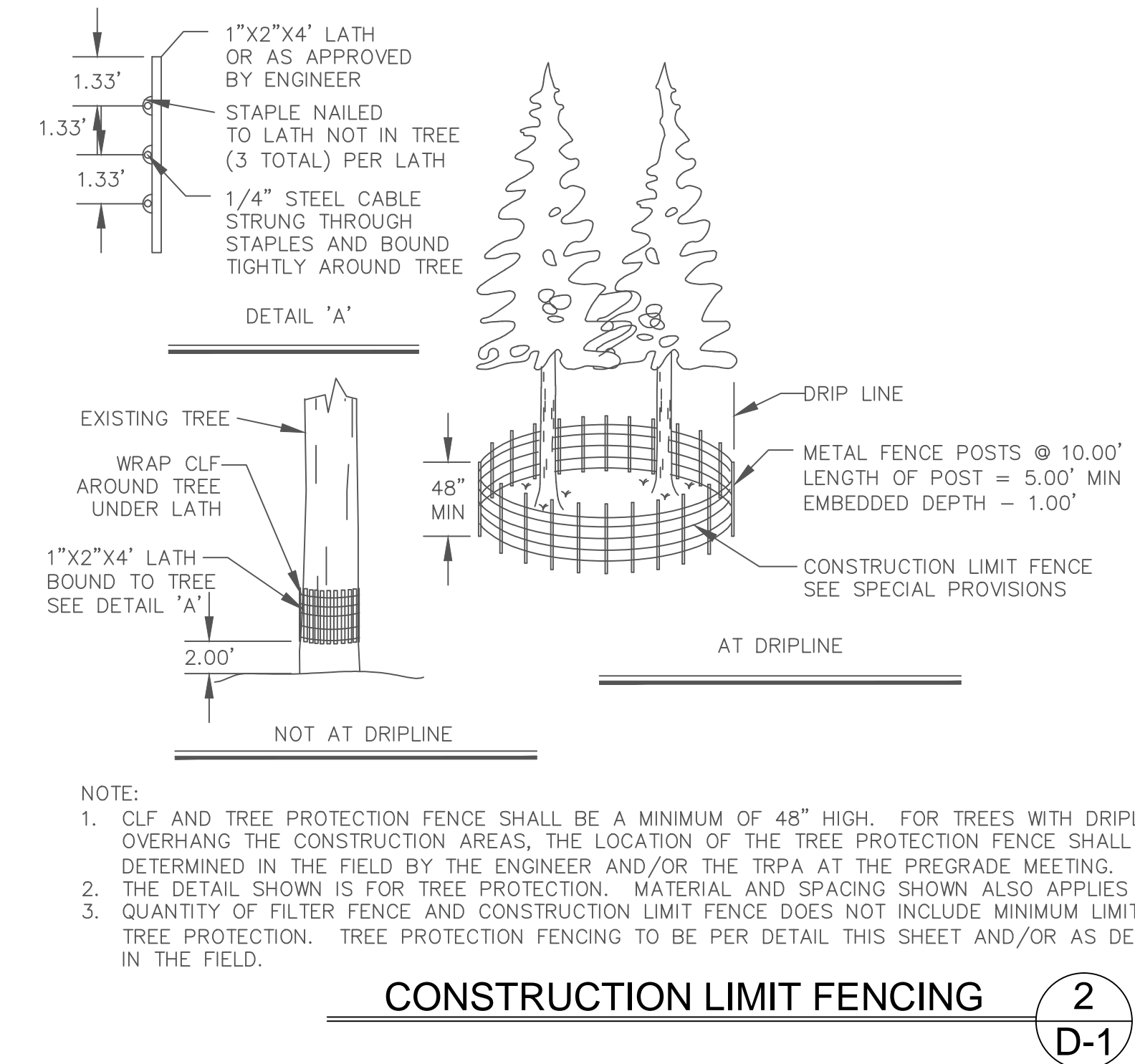
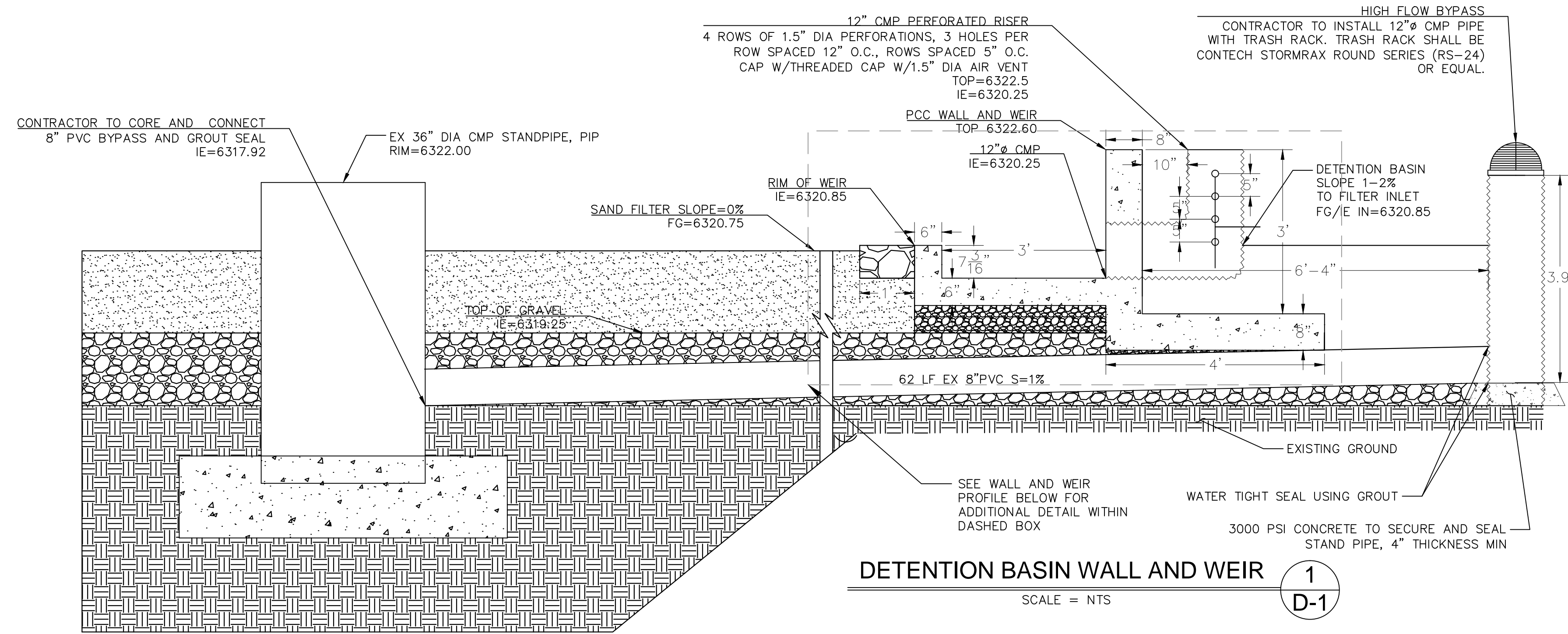

- NOTES:
1. PLACEMENT OF SEDIMENT LOGS IS SUBJECT TO EXISTING CONDITIONS. FINAL LOCATIONS TO BE DETERMINED BY THE ENGINEER IN THE FIELD.
 2. SEE SPECIAL PROVISIONS FOR SPECIFICATIONS REGARDING SEDIMENT LOG MATERIAL REQUIREMENTS.
 3. WEIGHTED SEDIMENT LOGS MAY BE NECESSARY ON PAVED AREAS.

- NOTE:
1. CLF AND TREE PROTECTION FENCE SHALL BE A MINIMUM OF 48" HIGH. FOR TREES WITH DRIPLINES THAT OVERHANG THE CONSTRUCTION AREAS, THE LOCATION OF THE TREE PROTECTION FENCE SHALL BE DETERMINED IN THE FIELD BY THE ENGINEER AND/OR THE TRPA AT THE PREGRADE MEETING.
 2. THE DETAIL SHOWN IS FOR TREE PROTECTION. MATERIAL AND SPACING SHOWN ALSO APPLIES TO CLF.
 3. QUANTITY OF FILTER FENCE AND CONSTRUCTION LIMIT FENCE DOES NOT INCLUDE MINIMUM LIMITS FOR TREE PROTECTION. TREE PROTECTION FENCING TO BE PER DETAIL THIS SHEET AND/OR AS DETERMINED IN THE FIELD.